

# STARTER SHAFT AND GEAR HOUSING - BELT DRIVE MODELS

## REMOVAL (Figure 5-16)

### WARNING

To prevent accidental start-up of vehicle and possible personal injury disconnect the battery cables (negative cable first) before performing any of the following procedures.

1. Remove starter. See STARTER MOTOR earlier in section.
2. Remove primary cover. See CLUTCH, section 6.
3. Remove outer drive gear housing (3) by removing the two hex head bolts, washers and lockwashers (1), and the one allen head screw (2).

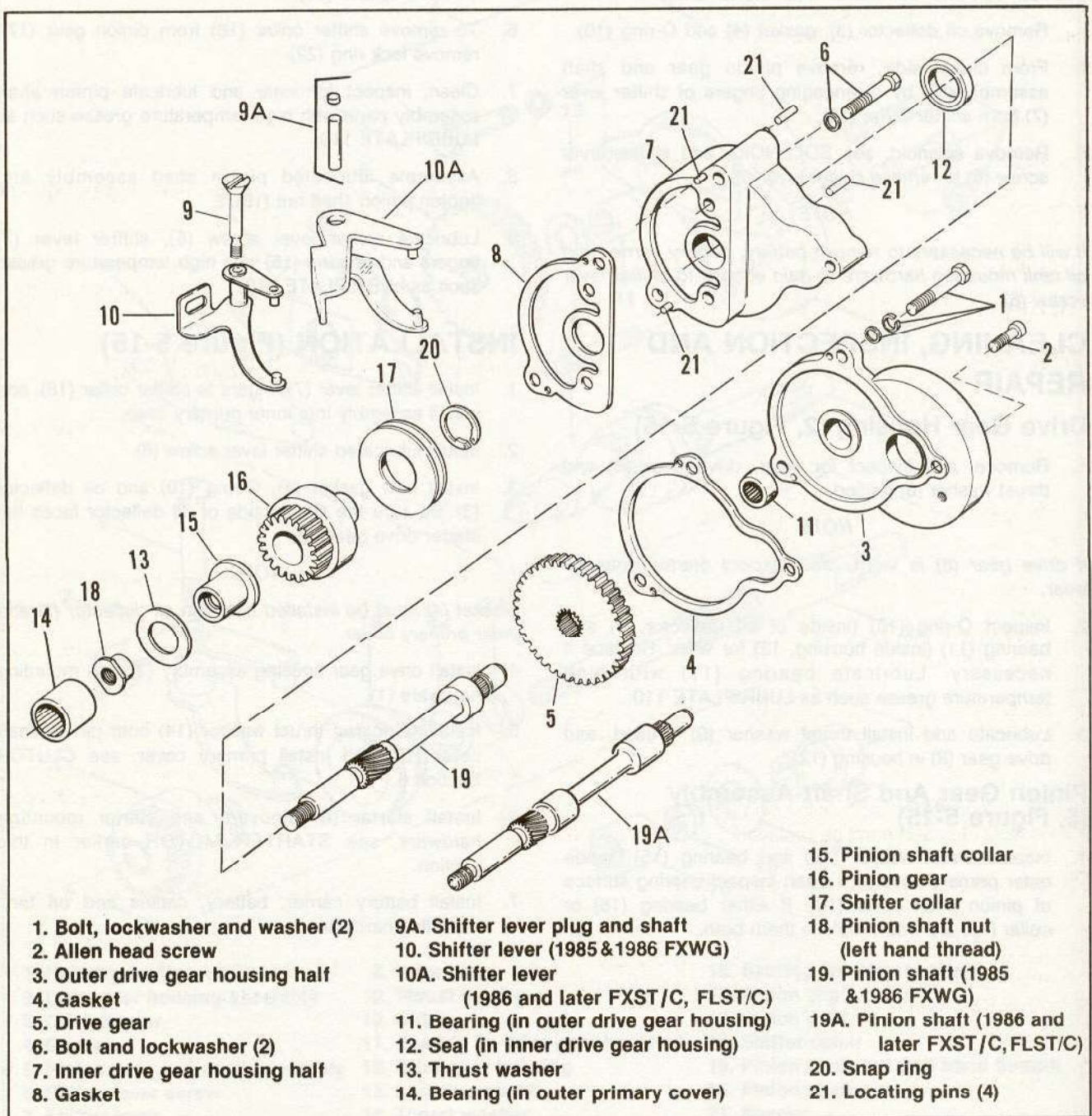

Figure 5-16. Starter Shaft Assembly and Drive Gear Housing - FXSB, FXWG, 1986 & Later FXST/C, FLST/C