

Replacing the side door lock units

Preparations

Check that the window is in the up position.

Removing the panel trim

Remove the panel trim according to [Front and rear doors](#) , VIDA: S70/V70/C70, 1998–1999, Group of functions 8, Repairing, Removing, replacing and installing, 83 Doors and hatches, Doors, Front and rear door, Door panel, step 7.

Removing door panel

Remove the door panel according to [Front and rear doors](#) , VIDA: S70/V70/C70, 1998–1999, Group of functions 8, Repairing, Removing, replacing and installing, 83 Doors and hatches, Doors, Front and rear door, Door panel, step 6.

Removing the cover (front door)

Remove the panel (1).
Remove the cable from the door panel.

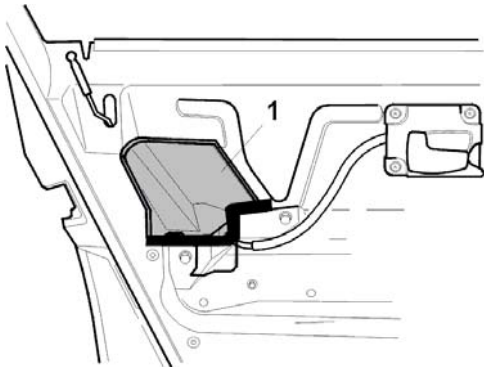

Removing the lock button (front door)

Disconnect the bar (1) from the lever and remove it.



Removing the panel (back door)

Remove the panel (1).
Remove the cable (2) from the door panel.

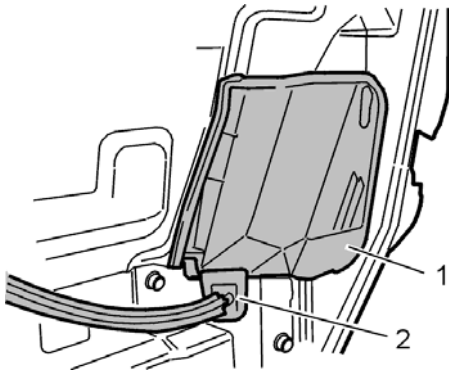

Removing the lock button (rear door)

Disconnect the lock button (1) from the mounting and remove it.

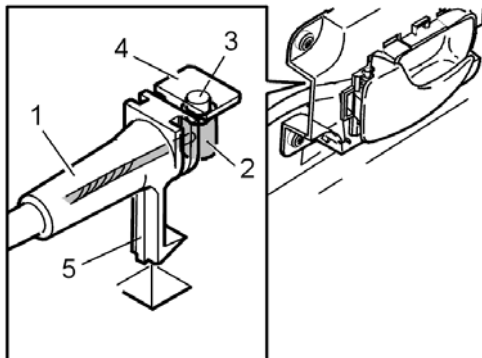
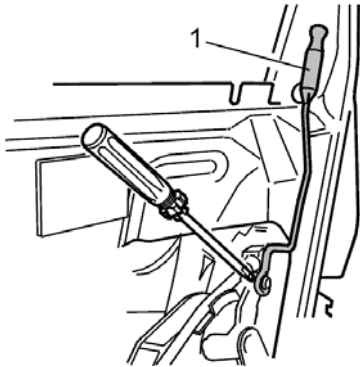

Removing the cable in the inner door opener

Remove the inner door opener from the door panel.

Carefully bend the hook out (5). Remove the end of the cable (1) from the internal door opener.

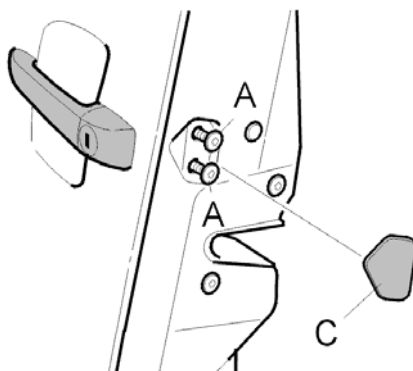

Disconnecting the external handle (front door)

Remove:

- panel (C),
- screws (A), Torx 30.

Removing the lock unit

Remove screws (B), Torx 30.

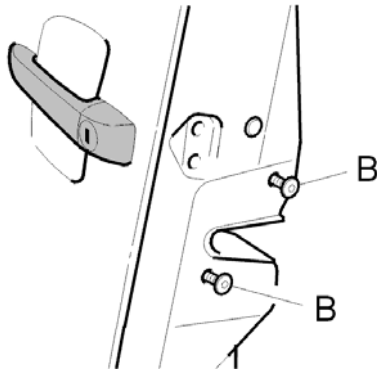

Disconnecting the connectors

Disconnect the connectors (1 and 2) from the lock unit.

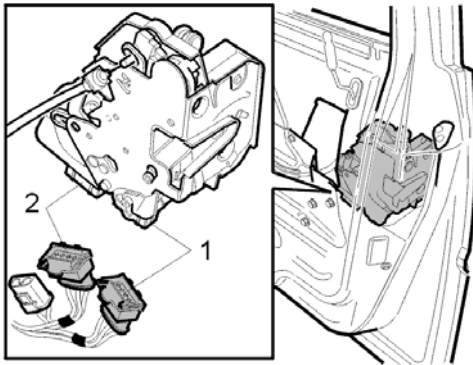

Disconnecting the external handle and lock unit (front door)

Rotate the lock unit carefully around the guide rail of the window so that the external handle can be slackened off slightly.
Continue to rotate the lock unit carefully around the guide rail of the window so that the lock unit can be removed from the door.

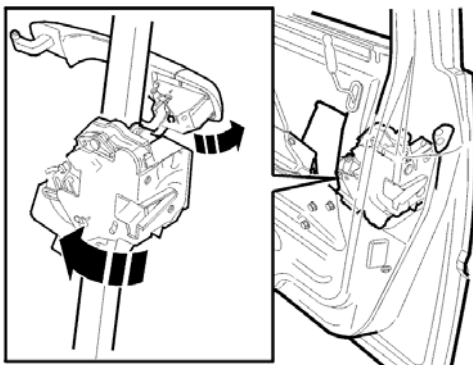

Disconnecting the lock cylinder (driver's side, front door)

Pull the handle out from the door a little, without disconnecting the handle from the door.
Carefully remove the cover (3). Begin at (4) and pull straight out. Take care with the painted surface.
Slacken off the locking spring (5) and press out the lock cylinder using the link (large arrow).

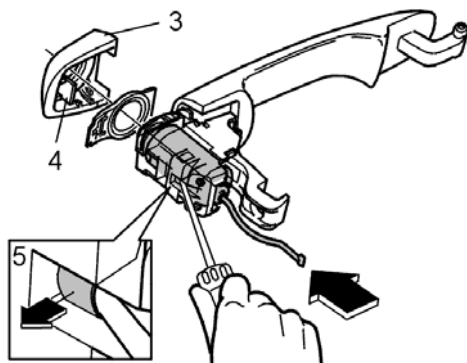

Disconnecting the guide rail (rear door)

Remove the guide rail lower screw (1).

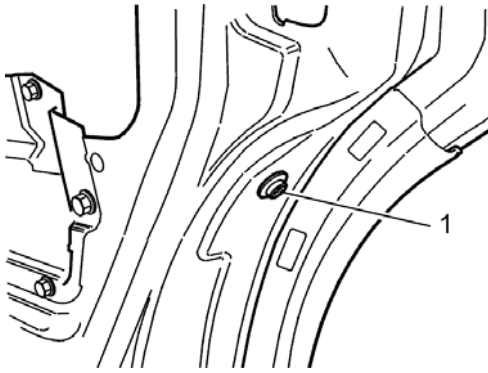

Disconnecting the lock unit (rear door)

Note! The guide rail must not move more than 30 mm laterally from the lower mounting point.

Continue to rotate the lock unit carefully around the guide rail of the window so that the lock unit can be removed from the door.

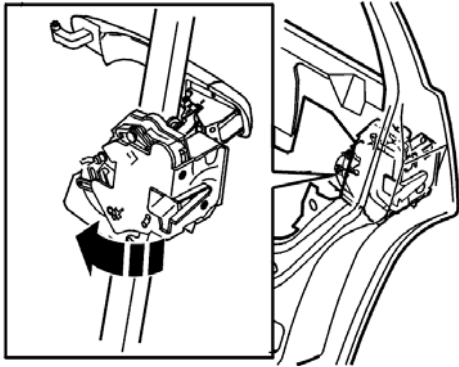

Preparations for the new lock unit (driver's side, front door)

Check that the holes (2) for the link (1) are in position as illustrated.

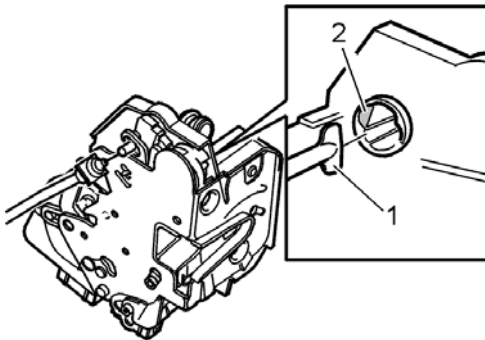

Installing the locking unit (front door)

Rotate the new lock unit around the guide rail of the window.

Install only one new screw (B). The screws should only be tightened sufficiently so that the lock unit is held in position (maximum 2 turns).

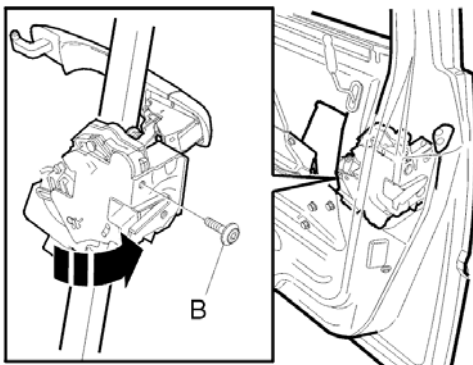

Disconnecting the lock unit (rear door)

Carefully hold the guide rail to one side. Rotate the new lock unit around the guide rail of the window. Screw only one new screw into place

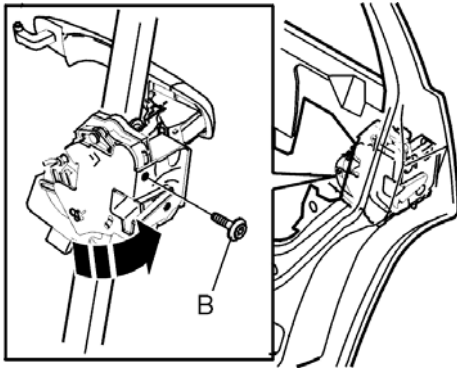

(B). The screw should be tightened sufficiently to hold the lock unit in position (maximum 2 turns).

Note! The guide rail must not move more than 30 mm laterally from the lower mounting point.

Installing the external handle

Turn the upper contact point of the opening arm to its outermost position against the outer panel.

Pull the contact point of the opening arm to the outer most position from the doors rear short side.



Installing the external door handle (continued)

Locate the hook of the external door handle on the upper contact point of the opening arm. Check the function by pulling the external handle.

Install another new screw (B) in the lock unit and tighten.

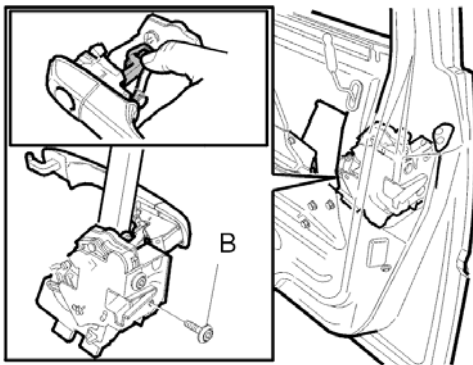

Removing switches

Install the connector on the lock unit. Gray connector to (1) and black connector to (2).

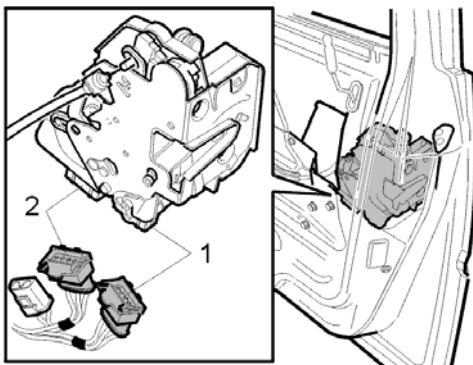

Installing the handle (front door)

Press the door handle hard against the bodywork. At the same time install screws (A). Tighten to **10+-2.5Nm**. Install the cover (C).

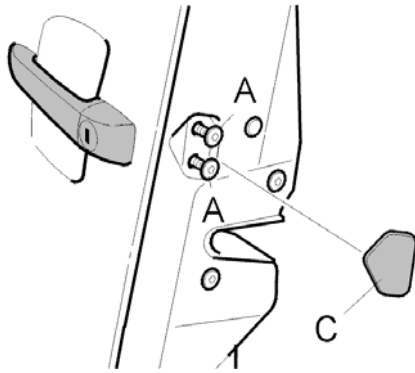

Disconnecting the lock cylinder (driver's side, front door)

Install the lock cylinder(1).
Check the function of the lock cylinder with the key **without** shutting the door.
Install the cover (2).

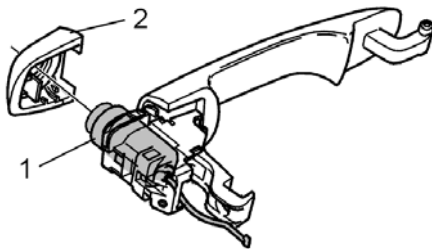

Installing the lock unit

Tighten screws (B) to **10+-2.5Nm**.
Check the mechanical function of the handle and lock, **without** shutting the door.

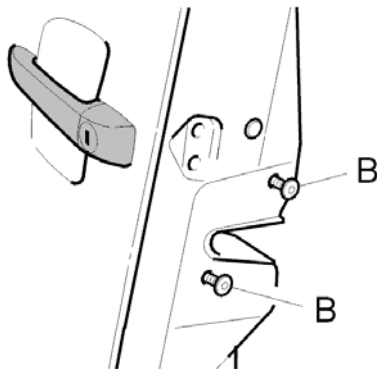

Installing the lock button (front door)

Install the bar(1).



Installing the cover (front door)

Install the cable in the door panel.
Install the panel (1).

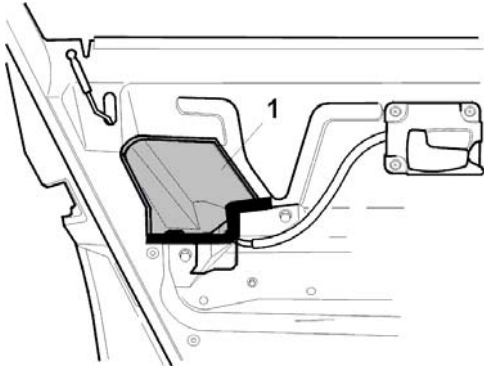

Installing the lock button (rear door)

Install the lock button (1) in its mounting.



Installing the cable and the panel (rear door)

Install the cable (2) in the door panel.
Install the panel (1).

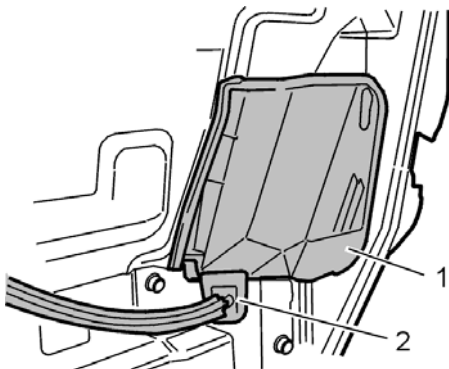

Installing the cable in the inner door opener

Press the end of the cable(2) into place on the guide(3) before the end of the cable sleeve(1) is pressed into the door opening module. Ensure that the hook (5) engages properly. Remove the lock (4) when the end of the cable sleeve(1) is secured, so that the cable (2) can move freely. Check the function. Install the door opening module. Check the mechanical functions of the handle and the lock.

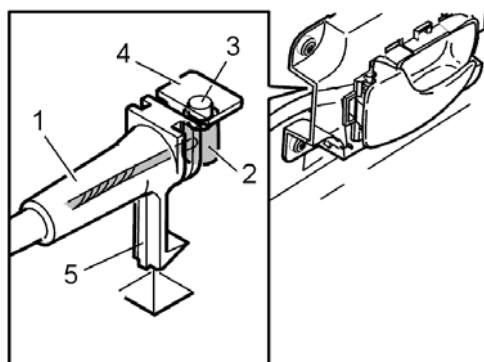

Installing the door panels

Install the door panel according to [Front and rear doors](#) , VIDA: S70/V70/C70, 1998–1999, Group of functions 8, Repairing, Removing, replacing and installing, 83 Doors and hatches,

Doors, Front and rear door, Door panel, step 6.

Function test

Check:

- the function by opening and closing the door,
- check the function of the lock with the key and the remote control,
- central locking system from interior,
- power windows,
- door mirrors.