

# SERVICE BULLETIN



M-1183A

Safety Recall Code 0124

June 30, 2006

## SAFETY RECALL 0124–2006 DYNA TRANSMISSION

### Purpose

The purpose of this revised service bulletin is to inform the dealer network of a change to the recall kit part number and the detent arm kit assembly. The revised recall kit part number is 94445A. Both the early and late kits are acceptable for installation. Use existing inventory of the 94445 kits before installing the 94445A kits.

Harley-Davidson Motor Company, Inc. has learned that a condition affecting safety exists on 2006 Dyna models. The transmissions in these motorcycles have a defect which may allow them to go into a false neutral position even though the neutral indicator light is illuminated. If this happens the transmission could engage into first or second gear unexpectedly and create the risk of a crash and injuries.

In the interest of motor vehicle safety and customer satisfaction, Harley-Davidson has elected to initiate a voluntary recall (Campaign 0124) to allow us to formally recall all affected vehicles. As required by law, you may sell but NOT DELIVER any affected motorcycles to your customers until the recall is performed.

See **Required Dealer Action** to perform the recall service.

### Motorcycles Affected

This campaign involves all 2006 Dyna FXDI, FXDLI, FXDBI, FXDCI, FXDI35 and FXDWGI models built between June 9, 2005 and October 19, 2005 and sold in all U.S. and non-U.S. markets.

### Customer Notification

In accordance with Federal regulations administrated by NHTSA, Harley-Davidson Motor Company, Inc. will provide notice to all owners of record of affected products with direction to bring the vehicle in for the recall service.

To protect the safety of our riders, it is our mutual responsibility to ensure the recall service is performed on all affected motorcycles. Therefore, we strongly urge you to perform the recall service even if the motorcycle was not purchased from your dealership.

You are also required to perform the recall service on all affected vehicles in your dealership inventory prior to delivering, renting or leasing those vehicles.

If you are not sure that a safety recall has been completed on a particular motorcycle, check the recall records available on TALON and h-dnet.com

#### IMPORTANT NOTE

***Because only registered owners will receive notification from us, we request that you contact any owners of vehicles that your records show as unregistered. Advise them of the safety recall and make arrangements for them to come in for recall service. We also require that you provide us with their names, addresses and VINs as soon as possible to enable us to mail them an owner's letter, as required by the National Traffic and Motor Vehicle Safety Act (as amended).***

Initial shipments will be made the week of December 12, 2005. All kits will be shipped no charge, transportation paid. If additional kits are needed, fill in attached order form and fax it to the warranty department at 414-343-8346. Be sure to include your dealer number on the order form.

#### NOTE

*No kit orders will be accepted prior to availability date.*

#### IMPORTANT NOTE

In the interest of preserving customer safety and satisfaction, always check for outstanding recalls whenever any motorcycle is brought into your dealership for either maintenance or service.

ROUTING	SERVICE MANAGER	SALES MANAGER	PARTS MANAGER	LEAD TECHNICIAN	TECHNICIAN NO.1	TECHNICIAN NO. 2	TECHNICIAN NO. 3	TECHNICIAN NO. 4	RETURN THIS TO
INITIAL HERE									

©2006 HARLEY-DAVIDSON MOTOR COMPANY

## Required Dealer Action

### NOTE

Refer to PHD 171 for additional details.

## Disassembly

### IMPORTANT NOTE

**It is imperative that you follow this procedure in the exact sequence listed, performing each step exactly as instructed. Do not deviate from this procedure in any way.**

1. Drain primary chaincase lubricant. See 1.11 PRIMARY CHAINCASE LUBRICANT in DYNA MODELS SERVICE MANUAL.
2. Drain transmission lubricant. See 1.13 TRANSMISSION LUBRICANT in DYNA MODELS SERVICE MANUAL.

### WARNING

**To prevent accidental vehicle start-up, which could cause death or serious injury, disconnect negative (-) battery cable before proceeding. (00048a)**

3. Disconnect negative battery cable from battery. See 1.5 BATTERY MAINTENANCE in DYNA MODELS SERVICE MANUAL.
4. Remove exhaust system as an assembly. See REMOVAL under 4.16 EXHAUST SYSTEM in DYNA MODELS SERVICE MANUAL.
5. See Figure 1. Remove screw (4), washer (3), two nuts (2) and rear exhaust bracket (1) from transmission case.

### NOTE

After removing the six clutch release cover screws in the next step, squeeze the clutch lever to help break the cover free.

### CAUTION

**Do not attempt to remove clutch release cover by prying against clutch cable fitting. Damage to clutch cable fitting can result.**

6. See Figure 2. Remove six screws that hold clutch release cover in place. Remove clutch release cover and discard cover gasket.

### NOTE

In the next step, loosen both axle adjusters an equal number of turns to maintain rear wheel alignment.

7. See Figure 3. Loosen rear axle nut (2). Do not remove rear axle retaining ring (3). Loosen both axle adjusters (1) about three turns to release tension on drive belt.

### NOTE

Do not re-tension drive belt until instructed to do so, later in this procedure.

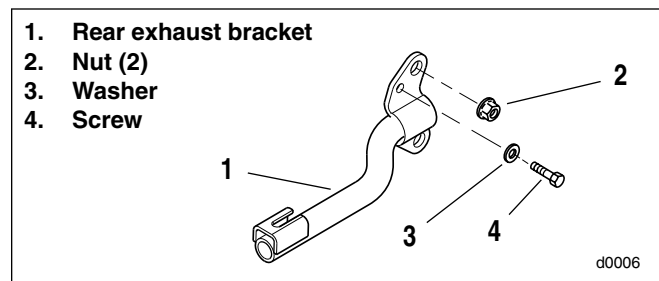

Figure 1. Rear Exhaust Bracket Mounting

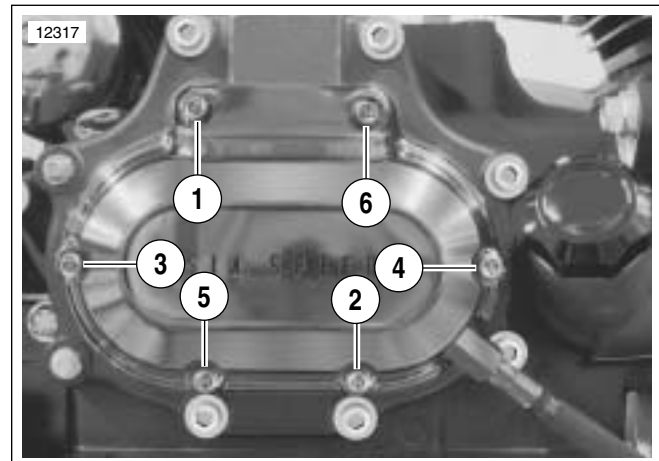

Figure 2. Clutch Release Cover Screws  
(Showing Screw Tightening Sequence)

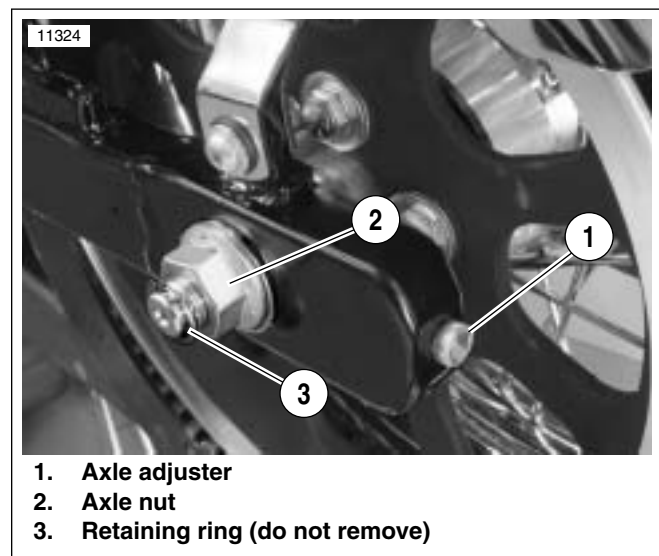

Figure 3. Axle Adjusters

8. Models with mid-mount foot controls:
  - a. See Figure 4. Remove two screws (1), washers (2) and left rider footrest assembly (3).
  - b. See Figure 5. Using a felt marker or grease pencil, mark position of shift lever (1) on shift shaft. Remove screw (2), washer (3) and shift lever.

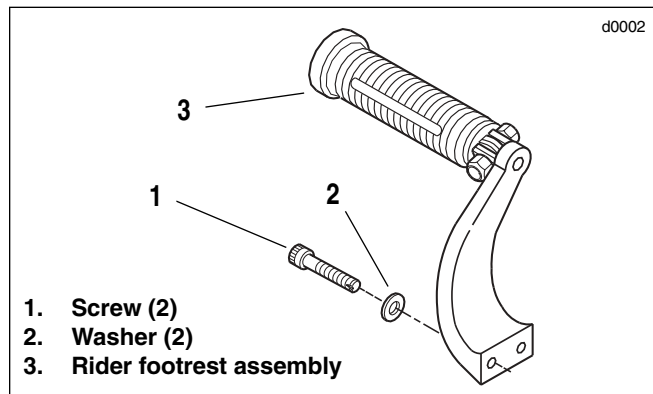

Figure 4. Left Rider Footrest Assembly

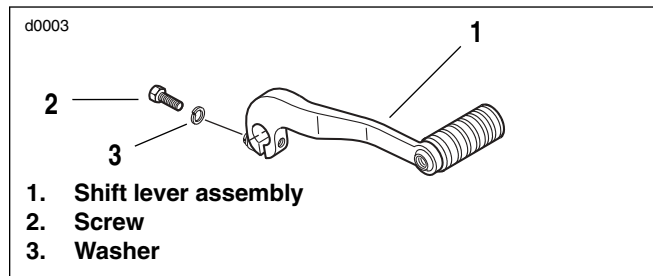

Figure 5. Shift Lever

9. Remove clutch cover. See 1.12 CLUTCH in DYNA MODELS SERVICE MANUAL.
10. Remove primary cover. See 6.2 PRIMARY CHAINCASE in DYNA MODELS SERVICE MANUAL.
11. Remove two screws that secure starter motor assembly to inner primary housing. Pull starter motor toward right side of vehicle slightly to disengage starter housing from inner primary housing. See Removal under 5.4 STARTER in DYNA MODELS SERVICE MANUAL.

#### NOTE

*It is not necessary to remove the starter motor assembly from the vehicle.*

#### CAUTION

**See Figure 6. Do not use HD-41214 Primary Drive Locking Tool to remove or install components. Damage to components can occur if this tool is used. Use only HD-47977 Primary drive locking tool to remove and install components.**

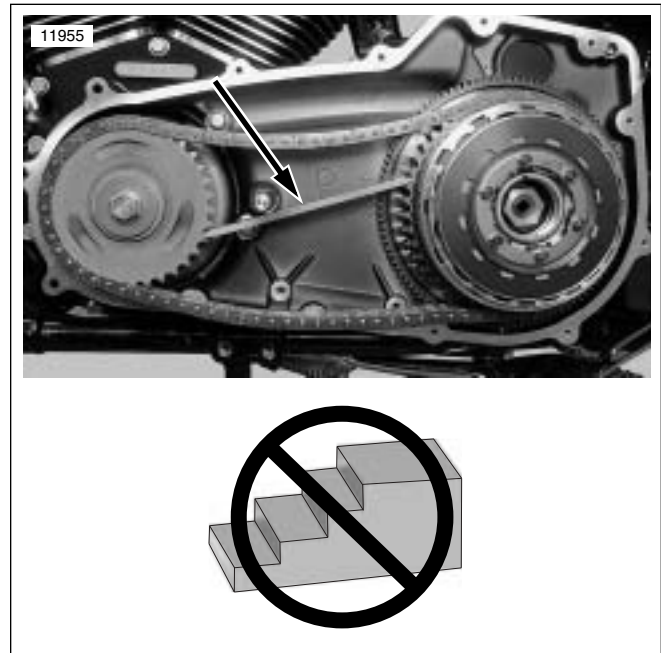

Figure 6. Primary Drive Locking Tool

12. Remove the following components. See Primary Chain and Compensating Sprocket Removal under 6.3 DRIVE COMPONENTS in DYNA MODELS SERVICE MANUAL.
  - a. Primary chain tensioner assembly.
  - b. Clutch release plate retaining ring. Discard retaining ring.
  - c. Clutch release plate, locknut and adjusting screw (remove as an assembly).
  - d. Clutch assembly, compensating sprocket assembly and primary chain (remove as an assembly).

## CAUTION

Cover transmission mainshaft splines with seal protector sleeve from MAIN DRIVE GEAR SEAL INSTALLER (Part No. HD-41405) or tape to prevent splines from damaging inner primary housing bearing.

13. See Figure 7. Remove five sealing fasteners (2) securing primary chaincase housing (4) to engine crankcase and transmission. Remove primary chaincase housing from vehicle. Discard crankcase gasket (5).
14. Remove seal protector sleeve (or tape) from mainshaft splines.

## NOTES

- U.S. dealers only: retain sealing fasteners; they will be returned to Harley-Davidson.
  - Do not remove transmission sprocket nut.
15. All models with mid-mount foot controls: remove and discard tower gasket (3) that seals shifter shaft boss.
  16. Remove mainshaft oil seal (1) from mainshaft bearing bore on transmission side of primary chaincase housing. Discard oil seal.
  17. Remove transmission top cover. Leave top cover gasket in place temporarily. Place shift cam pawl on top cover gasket surface. See REMOVAL under 7.5 TRANSMISSION ASSEMBLY in DYNA MODELS SERVICE MANUAL.

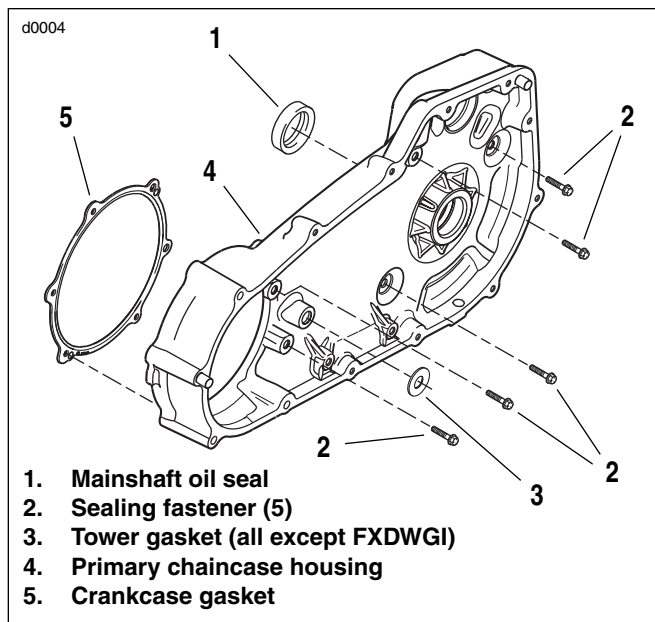

Figure 7. Primary Chaincase Housing

## NOTE

It may be helpful to move starter motor assembly to the left slightly to gain additional access to neutral switch in the next step.

18. Remove neutral switch. See REMOVAL under 8.27 NEUTRAL SWITCH in DYNA MODELS SERVICE MANUAL.

## NOTE

U.S. dealers only: retain neutral switch; it will be returned to Harley-Davidson.

## CAUTION

Do not attempt to remove transmission assembly from case by tapping on the mainshaft from opposite side. If you tap on the mainshaft with a hammer, you can damage the bearings in the bearing housing.

19. Remove transmission assembly from case as follows. See REMOVAL under 7.5 TRANSMISSION ASSEMBLY in DYNA MODELS SERVICE MANUAL.
  - a. Remove primary bearing inner race from transmission mainshaft using BEARING RACE PULLER AND INSTALLATION TOOL (Part No. HD-34902-B). Discard inner race.
  - b. Remove oil slinger assembly from mainshaft. Do not disassemble slinger.
  - c. Remove engine oil dipstick and oil spout. Discard oil spout o-ring. Cover oil spout hole to prevent contamination of engine oil.
  - d. Remove transmission oil dipstick.
  - e. Remove bearing housing mounting hardware. Use pry points on bearing housing to carefully pry housing loose.
  - f. Remove bearing housing, mainshaft assembly, countershaft assembly and shift cam assembly from transmission case as a complete assembly. Discard housing gasket.
  - g. Remove clutch release pushrod from hole in mainshaft.

## NOTES

- Do not remove mainshaft or countershaft assemblies from transmission bearing housing.
- Do not remove main drive gear from transmission case.

**NOTE**

See Figure 8. In the next step use a screw extractor to remove shift fork shafts.

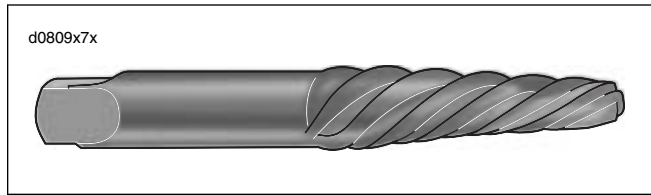

**Figure 8. Screw Extractor**

20. See Figure 9. With access door on end (shafts pointing upward), remove shift fork shafts (2) using screw extractor—not flute design (1). Shafts have slight interference fit. Shafts can be reused; do not damage end of shaft. Do not remove shift forks from shift fork shafts. Remove each shaft and shift fork(s) as a unit.
21. Remove two screws (4) and lock plate (5). Discard screws.

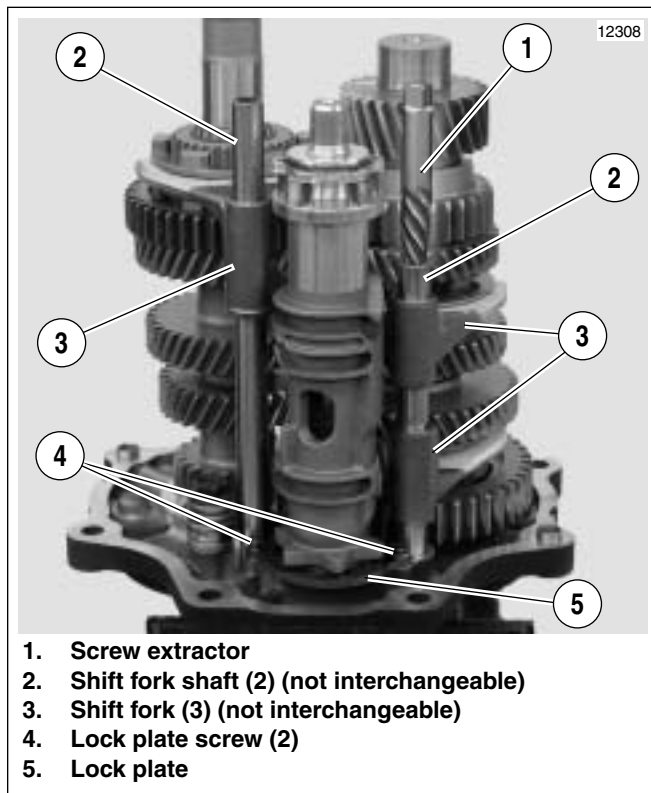
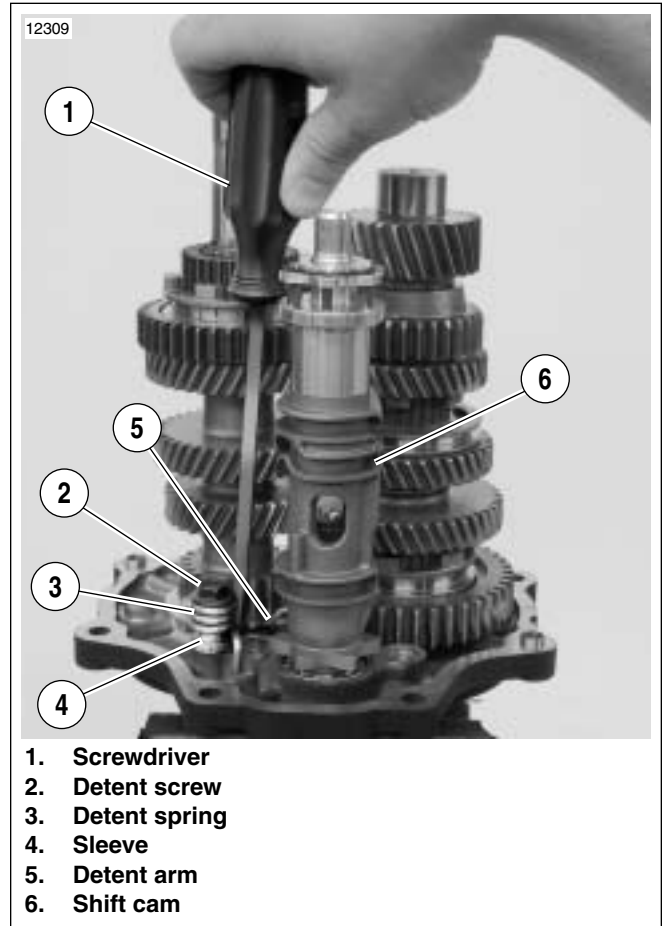

**Figure 9. Transmission Gear Assembly with Shift Forks and Shift Cam**

22. See Figure 10. Insert screwdriver (1) and gently pry back detent arm (5) to remove detent spring (3) tension from shift cam (6). Remove shift cam.
23. Remove detent screw (2), detent spring, sleeve (4) and detent arm. Discard detent screw.

**NOTE**

U.S. dealers only: retain old shift cam and detent arm; they will be returned to Harley-Davidson.



**Figure 10. Shift Cam and Detent Assembly**

## Assembly

### NOTE

If installing the 94445 recall parts kit, replace existing parts with parts listed in Table 1. If installing the 94445A recall parts kit, replace existing parts with parts listed in Table 2.

**Table 1. 94445 Recall Parts Kit List**

Old Part No.	Recall Kit Part No.	Qty	Description
	17369-06*	1	Gasket service kit
786**	786A	5	Inner primary fastener
11573	Same	1	Oil fill spout O-ring
12052A	Same	1	Primary mainshaft seal
12077	Same	1	Mainshaft oil seal
27444-00Y	Same	1	Starter O-ring
33387-06**	33409-06A	1	Detent arm and spring assembly
33913-06**	33926-06	1	Neutral switch
34091-06	Same	1	Primary bearing inner race
34917-06	Same	1	Transmission top cover gasket
34934-06	Same	1	Crankcase gasket
35228-06**	33413-06	1	Shift cam assembly
35244-06	Same	1	Detent screw
35259-06	Same	2	Shift cam lock plate screw
35654-06	Same	1	Bearing housing gasket
36805-06	Same	1	Clutch release cover gasket
37909-90	Same	1	Clutch release plate retaining ring
60547-06	Same	1	Primary cover gasket
63869-06	Same	1	Tower gasket
65324-83A	Same	2	Exhaust port gasket
<p>* Includes 1) Clutch cover seal (not sold separately) and 3) 11105 O-rings.</p> <p>** Parts to be returned to Harley-Davidson.</p>			

**Table 2. 94445A Recall Parts Kit List**

Old Part No.	Recall Kit Part No.	Qty	Description
	17369-06*	1	Gasket service kit
786**	786A	5	Inner primary fastener
11573	Same	1	Oil fill spout O-ring
12052A	Same	1	Primary mainshaft seal
12077	Same	1	Mainshaft oil seal
27444-00Y	Same	1	Starter O-ring
33387-06**	33409-06B	1	Detent arm
33913-06**	33926-06	1	Neutral switch
34091-06	Same	1	Primary bearing inner race
34917-06	Same	1	Transmission top cover gasket
34934-06	Same	1	Crankcase gasket
35228-06**	33413-06A	1	Shift cam assembly
35244-06	Same	1	Detent screw
35259-06	Same	2	Shift cam lock plate screw
35654-06	Same	1	Bearing housing gasket
36805-06	Same	1	Clutch release cover gasket
37909-90	Same	1	Clutch release plate retaining ring
60547-06	Same	1	Primary cover gasket
63869-06	Same	1	Tower gasket
65324-83A	Same	2	Exhaust port gasket
<p>* Includes 1) Clutch cover seal (not sold separately) and 3) 11105 O-rings.</p> <p>** Parts to be returned to Harley-Davidson.</p>			



## ⚠ WARNING

Compressed air can pierce the skin and flying debris from compressed air could cause serious eye injury. Wear safety glasses when working with compressed air. Never use your hand to check for air leaks or to determine air flow rates. (00061a)

### NOTE

When you are instructed in a step to clean fastener threads or threaded holes, proceed as follows: Clean all LOCTITE material from fastener threads and threaded holes. Use a wire brush to clean fastener threads. Use a thread chaser or other suitable tool to clean threaded holes. **Do NOT use a tap as this may remove metal from threaded holes.** Use PJ-1 cleaner or equivalent to remove all traces of oil and contaminants from threads. Blow out all threaded holes with low pressure compressed air.

1. Clean the following threaded holes:
  - shift cam lock plate mounting holes in transmission bearing housing,
  - detent screw mounting hole in transmission bearing housing.

### NOTE

If installing the 94445 kit, continue with step #2 below. If installing the 94445A kit, follow instruction sheet included in 33409-06B detent arm kit.

2. See Figure 11. Assemble **new** detent screw (1) (Part No. 35244-06 from recall parts kit), detent spring (2), sleeve (3) and **new** detent arm (4) (Part No. 33409-06 from recall parts kit). With transmission bearing housing mounted on end (shafts pointing upward), mount detent assembly in bearing housing as shown. Make certain to orient spring and detent arm as shown in the figure. Tighten screw to 120-150 **in-lbs** (13.6-17.0 Nm).

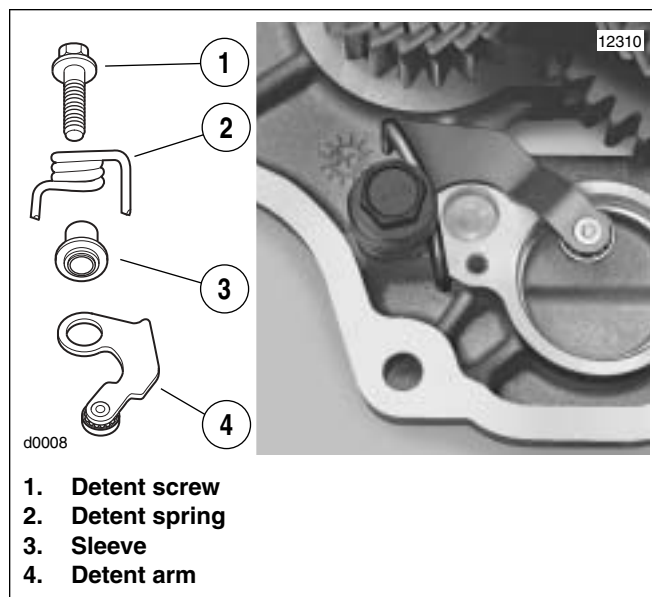

Figure 11. Detent Assembly

3. See Figure 10. Using screwdriver (1), pull detent arm (5) back and install **new** shift cam (6) (Part No. 33413-06 from recall parts kit).

## CAUTION

Do not allow detent arm to snap back against shift cam. Damage to shift cam, bearing, or detent arm wheel can result.

4. See Figure 9. Install lock plate (5) and **new** lock plate screws (4) (Part No. 35259-06 from recall parts kit) into transmission bearing housing. Tighten screws to 50-70 **in-lbs** (5.7-7.9 Nm).
5. See Figure 12. Make certain shift forks and shafts are assembled as shown.

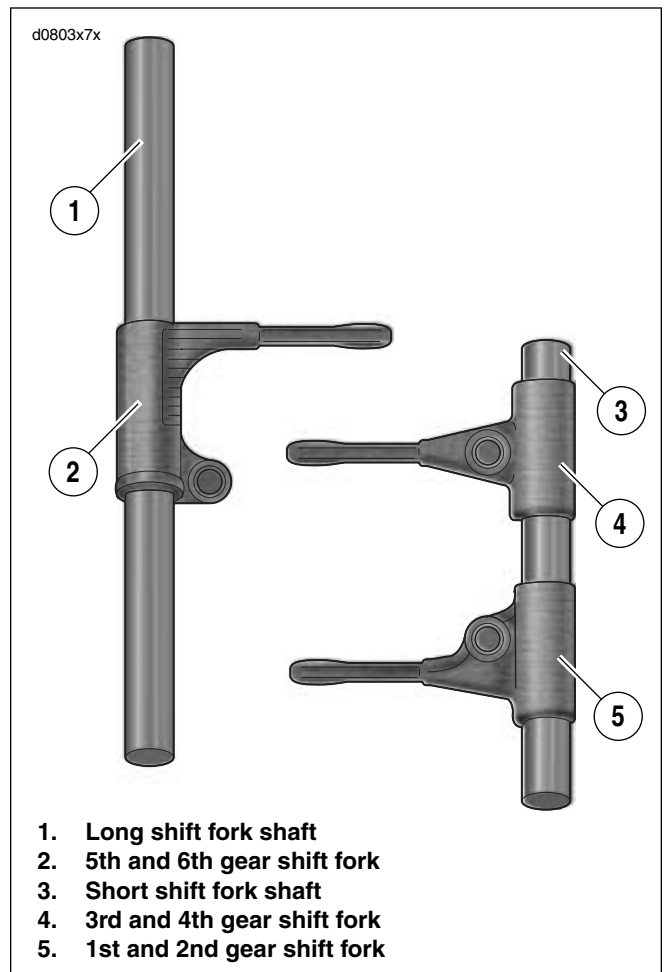
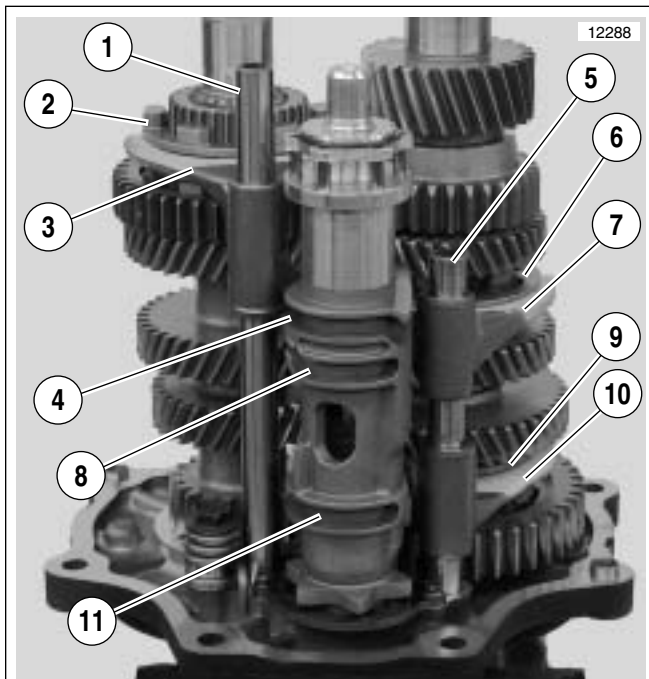

Figure 12. Shift Forks and Shafts

6. See Figure 13. Insert shift fork (3) into slot of dog ring (2) between mainshaft 5th and 6th gear. Ensure shift fork pin is in correct track (4) in shift cam.
7. Slide long shift fork shaft (1) down into hole in bearing housing. Gently tap on end of shaft with a soft faced mallet until shaft bottoms out in hole.
8. Insert shift fork (7) into slot of dog ring (6) between countershaft 3rd and 4th gear. Ensure shift fork pin is in correct track (8) in shift cam.
9. Insert shift fork (10) into slot of dog ring (9) between countershaft 1st and 2nd gear. Ensure shift fork pin is in correct track (11) in shift cam.
10. Slide short shift fork shaft (5) down and into hole in bearing housing. Gently tap on end of shaft with a soft faced mallet until shaft bottoms out in hole.



1. Long shift fork shaft
2. 5th and 6th gear dog ring
3. 5th and 6th gear shift fork
4. 5th and 6th gear shift fork pin track
5. Short shift fork shaft
6. 3rd and 4th gear dog ring
7. 3rd and 4th gear shift fork
8. 3rd and 4th gear shift fork pin track
9. 1st and 2nd gear dog ring
10. 1st and 2nd gear shift fork
11. 1st and 2nd gear shift fork pin track

Figure 13. Assembling Shift Forks and Shafts

11. Remove mainshaft oil seal from end of main drive gear.

**NOTE**

*Make sure transmission is not in 6th gear when installing into transmission case.*

12. Install transmission assembly into transmission case with a **new** bearing housing gasket (Part No. 35654-06 from recall parts kit). Install all bearing housing fasteners. Using crosswise pattern, tighten all fasteners to 13-18 ft-lbs (17.6-24.4 Nm). See INSTALLATION under 7.5 TRANSMISSION ASSEMBLY in DYNA MODELS SERVICE MANUAL.
13. Remove shift cam pawl from transmission top cover gasket surface and place on shift cam. Remove and discard old transmission top cover gasket.
14. Manually shift transmission through all gears while rotating mainshaft to ensure proper assembly.
15. Install **new** mainshaft seal (Part No. 12077 from recall parts kit). See 7.6 MAIN DRIVE GEAR AND BEARING in DYNA MODELS SERVICE MANUAL.

**NOTE**

*Mainshaft seal is properly installed when seal driver bottoms out against end of main drive gear.*

16. Shift transmission into first gear.

**NOTE**

*See Figure 14. The **new** mainshaft inner bearing race (Part No. 34091-06 from recall parts kit) must be positioned on the mainshaft a precise distance to properly align with bearing outer race in inner primary chaincase.*

**CAUTION**

**Do NOT press the inner race all the way against the main drive gear. If the inner race is pressed against the main drive gear, the inner race will be out of alignment with the bearing in the primary housing. This can result in premature bearing failure.**

17. See Figure 14. To install **new** mainshaft bearing inner race (1) (Part No. 34091-06 from recall parts kit), use those parts of the combination BEARING RACE PULLER AND INSTALLATION TOOL (Part No. HD-34902-B) that are shown in the figure.
  - a. Slide bearing inner race (1) onto mainshaft with numbered end of race facing away from main drive gear.
  - b. Thread sleeve pilot (2) onto end of mainshaft (left hand thread).
  - c. Position sleeve (3) over sleeve pilot and against bearing inner race.



- d. Place washer (4) over threaded portion of sleeve pilot and install nut (5).
- e. Tighten nut while holding sleeve pilot stationary with wrench on flats at end of screw threads. Press bearing inner race onto shaft so inside edge is 0.100-0.125 in. (2.540-3.180 mm) from main drive gear.

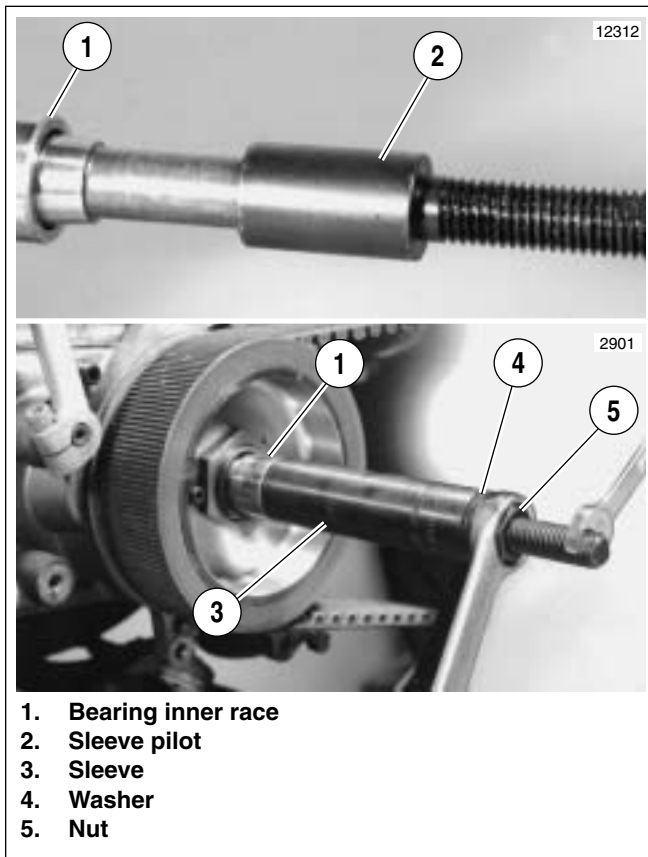

**Figure 14. Installing Mainshaft Inner Bearing Race**

18. Install clutch release push rod and oil slinger assembly into mainshaft hole.

**NOTE**

See Figure 2. The two top clutch release cover fasteners are shorter in length than the others.

19. See Figure 2. Install clutch release cover with a **new** gasket (Part No. 36805-06 from recall parts kit). Tighten screws in the pattern shown in the figure, to 84-108 **in-lbs** (9.5-12.2 Nm).

20. Install transmission top cover with a **new** gasket (Part No. 34917-06 from recall parts kit). Install top cover fasteners and tighten to 84-132 **in-lbs** (9.5-14.9 Nm).
21. Install oil spout with **new** o-ring (Part No. 11573 from recall parts kit). See INSTALLATION under 7.5 TRANSMISSION ASSEMBLY in DYNA MODELS SERVICE MANUAL. Install engine oil dipstick.
22. Shift transmission into neutral.
23. Install **new** neutral switch (Part No. 33926-06 from recall parts kit). See INSTALLATION under 8.27 NEUTRAL SWITCH in DYNA MODELS SERVICE MANUAL.
24. Install **new** inner primary housing mainshaft oil seal (Part No. 12052A from recall parts kit). See MAINSHAFT BEARING AND LIP SEAL under 6.2 PRIMARY CHAINCASE in DYNA MODELS SERVICE MANUAL. Note that the seal can be identified by the words "OIL SIDE", which must face the bearing.
25. Clean inner primary housing threaded mounting holes in crankcase and transmission case.
26. Thoroughly clean all mating surfaces of inner primary housing, engine crankcase and transmission case with PJ-1 cleaner or equivalent. All mating surfaces must be dry and oil-free.
27. Examine two split ring dowel bushings in inner primary housing where starter motor assembly mounts. If dowel bushings are loose, remove bushings and pry open slightly to provide an interference fit in primary housing. Reinstall bushings into primary housing.
28. Replace o-ring on end of starter housing with **new** o-ring (Part No. 27444-00Y from recall parts kit).

**CAUTION**

Cover transmission mainshaft splines with seal protector sleeve from MAIN DRIVE GEAR SEAL INSTALLER (Part No. HD-41405) or tape to prevent splines from damaging inner primary housing mainshaft oil seal and bearings.

**NOTE**

See Figure 15. In next step, be sure dowels (1) in **new** crankcase gasket (2) (Part No. 34934-06 from recall parts kit) engage holes in crankcase.

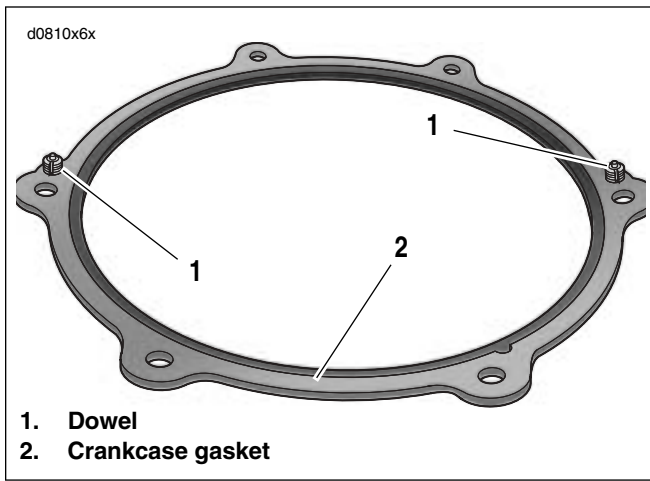

Figure 15. Crankcase Gasket

29. See Figure 16. Position **new** crankcase gasket (Part No. 34934-06 from recall parts kit) in place on gasket surface (1). Be sure dowels in gasket engage dowel holes (2) in crankcase.
30. Spread a thin film of oil on primary housing mainshaft oil seal lip and rubber portion of crankcase gasket.
31. Install primary housing. Be careful not to damage mainshaft seal when installing chaincase over primary bearing inner race on mainshaft.

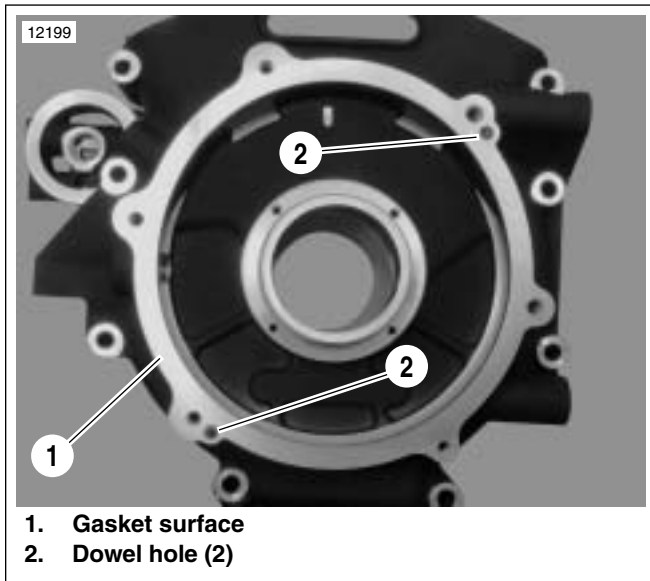

Figure 16. Crankcase

#### NOTE

See Figure 17. **New** sealing fasteners (Part No. 786A from recall parts kit) have different head markings and are 1/8 in. longer than old fasteners. New fasteners also have an orange lock patch.

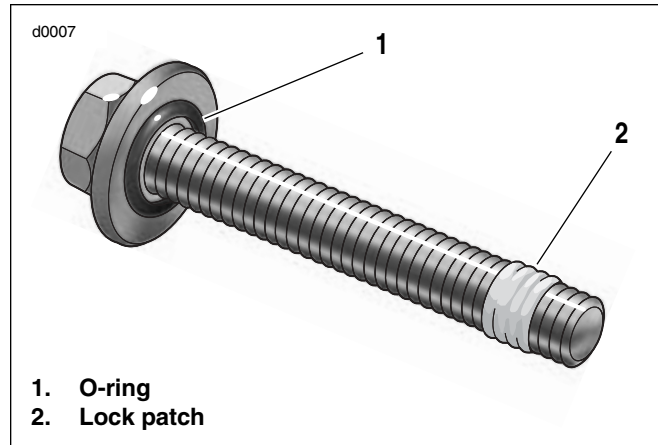
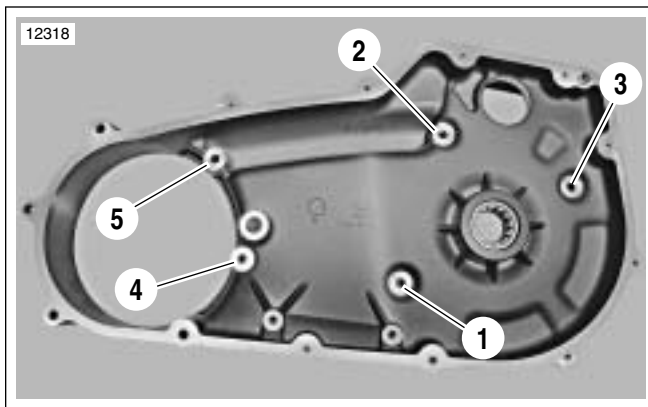

Figure 17. Sealing Fastener (Part No. 786A)

32. See Figure 18. Clean the faces of the five mounting screw bosses in the inner primary housing with PJ1 or equivalent. The boss faces must be clean and dry, free of any oil or other contaminants.
33. Insert five **new** sealing fasteners (Part No. 786A from recall parts kit). Start all five fasteners in holes. Then tighten fasteners in the sequence shown in the figure to 27 ft-lbs (36.6 Nm).
34. Remove seal protector sleeve (or tape) from transmission mainshaft splines.
35. Attach starter motor assembly to inner primary housing with two screws and washers. Tighten to 13-20 ft-lbs (17.6-27.1 Nm). See INSTALLATION under 5.4 STARTER in DYNA MODELS SERVICE MANUAL.
36. Clean the following fastener threads and threaded holes.
  - compensating sprocket bolt,
  - engine sprocket shaft threaded hole,
  - transmission mainshaft threads,
  - clutch hub mainshaft locknut.



**Figure 18. Sealing Fastener Tightening Sequence**

**NOTE**

*The primary chain, compensating sprocket and clutch assembly must be installed as an assembly.*

**CAUTION**

See Figure 19. Do not use HD-41214 Primary Drive Locking Tool to remove or install components. Damage to components can occur if this tool is used. Use only HD-47977 Primary drive locking tool to remove and install components.



**Figure 19. Primary Drive Locking Tool**

37. Install the following components. See Installation under 6.3 DRIVE COMPONENTS in DYNA MODELS SERVICE MANUAL.
  - a. compensating sprocket assembly, clutch assembly and primary chain as an assembly,
  - b. clutch release plate with locknut and adjuster screw; secure with **new** retaining ring (Part No. 37909-90 from recall parts kit),
  - c. chain tensioner assembly.
38. Adjust clutch. See Adjustment under 1.12 CLUTCH in DYNA MODELS SERVICE MANUAL.
39. Models with mid-mount foot controls: See Figure 7. Slide **new** tower gasket (3) (Part No. 63869-06 from recall parts kit) onto shift lever shaft and up against boss in inner primary housing (4).

**CAUTION**

The gasket between the primary chaincase cover and chaincase must be replaced each time the cover is removed. Failure to replace this gasket may cause primary chaincase leaks.

40. Install primary chaincase cover with **new** gasket (Part No. 60547-06 from recall parts kit). See 6.2 PRIMARY CHAINCASE in DYNA MODELS SERVICE MANUAL.
41. Models with mid-mount foot controls:
  - a. See Figure 5. Install shift lever (1) using alignment marks you previously made on shift lever and shift shaft. Secure with screw (2) and washer (3). Tighten to 18-22 ft-lbs (24.4-29.9 Nm). Remove alignment marks.
  - b. See Figure 4. Install left rider footrest assembly (3). Secure with two screws (1) and washers (2). Tighten to 25-35 ft-lbs (33.9-47.5 Nm).

42. Reinstall primary lubricant drain plug with a **new** o-ring (Part No. 11105, a component of 17369-06 Gasket service kit, contained in recall parts kit).
43. Fill primary chaincase with correct amount of FORMULA+ TRANSMISSION AND PRIMARY CHAINCASE LUBRICANT or SCREAMIN' EAGLE SYN3 SYNTHETIC MOTORCYCLE LUBRICANT. See 1.11 PRIMARY CHAINCASE LUBRICANT in DYNA MODELS SERVICE MANUAL. When re-installing clutch cover, use **new** clutch cover seal (a component of 17369-06 Gasket service kit, contained in recall parts kit).
44. Reinstall transmission lubricant drain plug with a **new** o-ring (Part No. 11105, a component of 17369-06 Gasket service kit, contained in recall parts kit).
45. Fill transmission with correct amount of FORMULA+ TRANSMISSION AND PRIMARY CHAINCASE LUBRICANT or SCREAMIN' EAGLE SYN3 SYNTHETIC MOTORCYCLE LUBRICANT and install transmission oil dipstick. See 1.13 TRANSMISSION LUBRICANT in DYNA MODELS SERVICE MANUAL.
46. See Figure 1. Install rear exhaust bracket (1) onto bearing plate mounting studs in transmission case. Secure with screw (4), washer (3) and two nuts (2). Tighten screw to 108-144 **in-lbs** (12.2-16.3 Nm). Tighten nuts to 100-120 **in-lbs** (11.3-13.6 Nm).
47. Install exhaust system. Use **new** exhaust port gaskets (Part No. 65324-83A from recall parts kit). See INSTALLATION under 4.16 EXHAUST SYSTEM in DYNA MODELS SERVICE MANUAL.
48. Adjust rear belt tension. See 1.14 REAR BELT DEFLECTION in DYNA MODELS SERVICE MANUAL. Make sure rear axle nut is tightened to 72-78 ft-lbs (97.6-105.7 Nm).
49. Connect battery negative cable. See 1.5 BATTERY MAINTENANCE in DYNA MODELS SERVICE MANUAL.
50. Road test vehicle.

## Credit Procedure—U.S. Market

### Procedure for Recall Repair Only

Complete a Dealer Service Card for each vehicle serviced. Be sure to list the Safety Recall Code 0124 on the card. Place a **C** in the letter box.

Package the five sealing fasteners (Part No. 786), detent arm assembly (Part No. 33387-06), neutral switch (Part No. 33913-06) and shift cam assembly (Part No. 35228-06) along with your properly completed Dealer Service Card, and send to: Harley-Davidson Motor Company, Warranty Return Dept., 3801 W. Juneau Ave., Milwaukee, WI 53208.

Upon receipt of parts listed above and the properly completed Dealer Service Card, you will be credited 3.3 hours of labor for performing the procedure, which includes the cost of materials (lubricant) and 0.1 hours for dealer administration time. You will also be credited the cost of return postage.

### Procedure for Recall Repair with Pick-up and Delivery of Vehicle

If the vehicle was picked up AND delivered by your dealership, please fill out the attached form completely. Dealership representative and customer **must** sign the form. Staple this form to the Dealer Service Card and include both of these items in the box with the parts listed above. Be sure to list Safety Recall Code 0124 on the card and place a **D** in the letter box.

Upon receipt of parts, properly completed Dealer Service Card and 0124 form, you will be credited 5.3 hours of labor for performing the procedure, which includes the cost of materials (lubricant), pick-up AND delivery of the vehicle, and 0.1 hours for dealer administration time. You will also be credited the cost of return postage. Please retain a copy of the completed form for your records.

#### **IMPORTANT NOTE**

***Properly completed 0124 form must be received along with parts and Dealer Service Card. Requests to accept these forms after receipt of parts and Dealer Service Cards will NOT BE HONORED.***

## Credit Procedure—Non-U.S. Market

### Procedure for Recall Repair Only

For each vehicle serviced, file a warranty claim supplying all the necessary information as follows:

Claim Type	RCL
Quantity	0
Replacement Part No.	94445 or 94445A
Part Description	Dyna Trans Recall Kit
Primary Labor Code	4317
Time	3.3
Customer Concern Code	0124
Condition Code	2105

### Procedure for Recall Repair with Pick-up and Delivery of Vehicle

If the vehicle was picked up AND delivered by your dealership, please fill out the attached form completely. Dealership representative and customer **must** sign the form. Please retain a copy of the completed form for your records.

Claim Type	RCL
Quantity	0
Replacement Part No.	94445 or 94445A
Part Description	Dyna Trans Recall Kit
Primary Labor Code	4318
Time	5.3
Customer Concern Code	0124
Condition Code	2105

## Credit Procedure for Dealership

### Stock of part Number 786–

### All Markets

Please file an electronic warranty claim for all of the sealing fasteners (Part No. 786) you currently have in stock. Please destroy all stock you have of this part.

<b>Claim Type</b>	DFS
<b>Quantity</b>	Depends on Dealer Stock
<b>Part No.</b>	786
<b>Part Description</b>	Sealing fastener
<b>Customer Concern Code</b>	0124
<b>Condition Code</b>	2105

Upon receipt of a properly completed warranty claim, you will be issued credit based upon the quantity you have claimed.

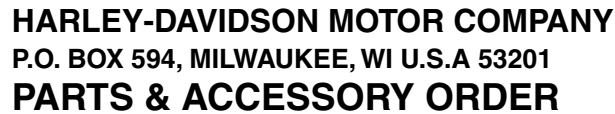

S  
O  
L  
D

NAME \_\_\_\_\_

ADDRESS \_\_\_\_\_

T  
O

CITY/STATE/ZIP \_\_\_\_\_

S  
H  
I  
P  
T  
O

NAME \_\_\_\_\_  
ADDRESS **SAME** \_\_\_\_\_  
CITY/STATE/ZIP \_\_\_\_\_

DEALER ORDER	
ORDER DATE	
DEALER NO.	
ORDER TYPE	<b>RC</b>
WARRANTY CLAIM NO.	

[illegible]

PLEASE USE PART NUMBERS  
DO NOT USE FOR  
CORRESPONDENCE



## Pick-up and Delivery of Vehicle Involved in The Safety Campaign 0124

Please Print VIN #:

--	--	--	--	--	--	--	--	--	--	--	--	--	--	--	--	--	--

Dealer #: \_\_\_\_\_ Name of Dealership: \_\_\_\_\_

Vehicle Pickup Date From Customer: \_\_\_\_/\_\_\_\_/\_\_\_\_ Vehicle Delivery Date To Customer: \_\_\_\_/\_\_\_\_/\_\_\_\_

Dealer's Signature: \_\_\_\_\_  
Print Dealer Signer's  
Name: \_\_\_\_\_

Customer's Signature: \_\_\_\_\_

Print Customer's Name: \_\_\_\_\_

Customer's Phone #: \_\_\_\_\_

Dealer has my permission to send my name and address to Harley-Davidson/Buell. I understand that this information will only be used in regards to this safety campaign.